

Smart Home Systems

User Manual



MyPlace User Manual

Contents

1 - INTRODUCTION	3
2 - CONTROLS	4
3 - HOME PAGE	5
4 - GROUP PAGE	6
5 - SCENES PAGE	7
6 - SCENES EDITOR PAGE	8
7 - SETUP PAGE	9

1 - INTRODUCTION

Welcome to your new MyPlace smart home system.

The information provided in this user manual will help you to get the most from your new home system.

Upon first power up, the system will take a few minutes to initialise. If you walk away from your screen it will go to sleep, to wake the screen simply double tap on a corner of the screen.

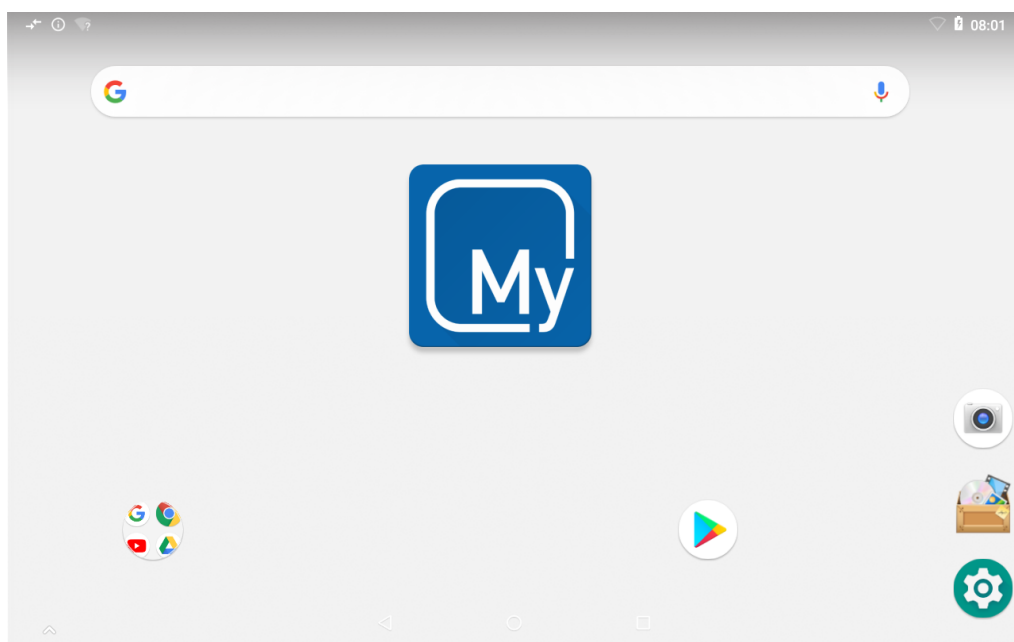

This is your home screen, press the large My button to start the MyPlace app. Once the MyPlace app has loaded press the purple MyPlace tab to start controlling your garage door, fans and roller blinds in your home.

MyPlace will send a garage notification to your wall mounted touch screen & smart device when you forget to close your garage door. You will need an internet connection to receive the notification.

HINT: Smart Khaya and Garage notification need remote access enabled to work.

2 - CONTROLS

The following shows the types of buttons that may be found in your MyPlace system.

Up/Down Button (Garage & Blinds)

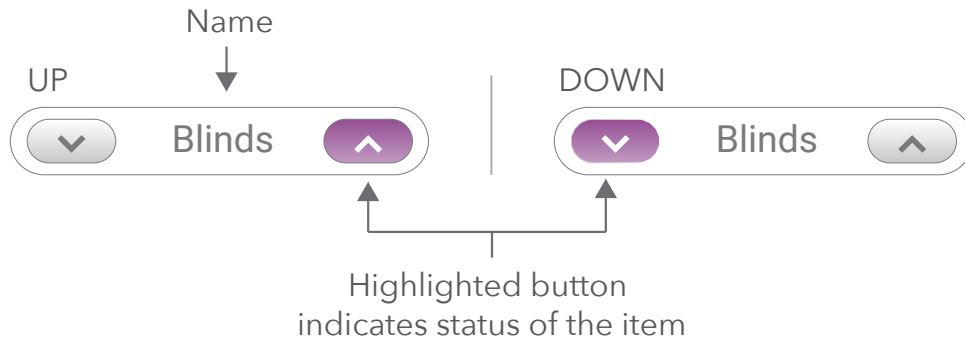

Other Buttons

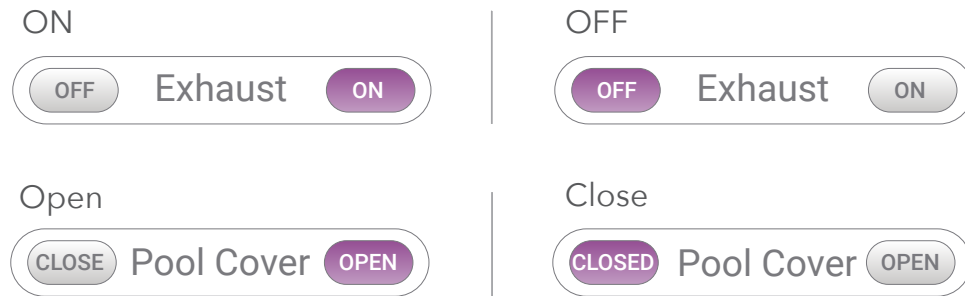

Group button

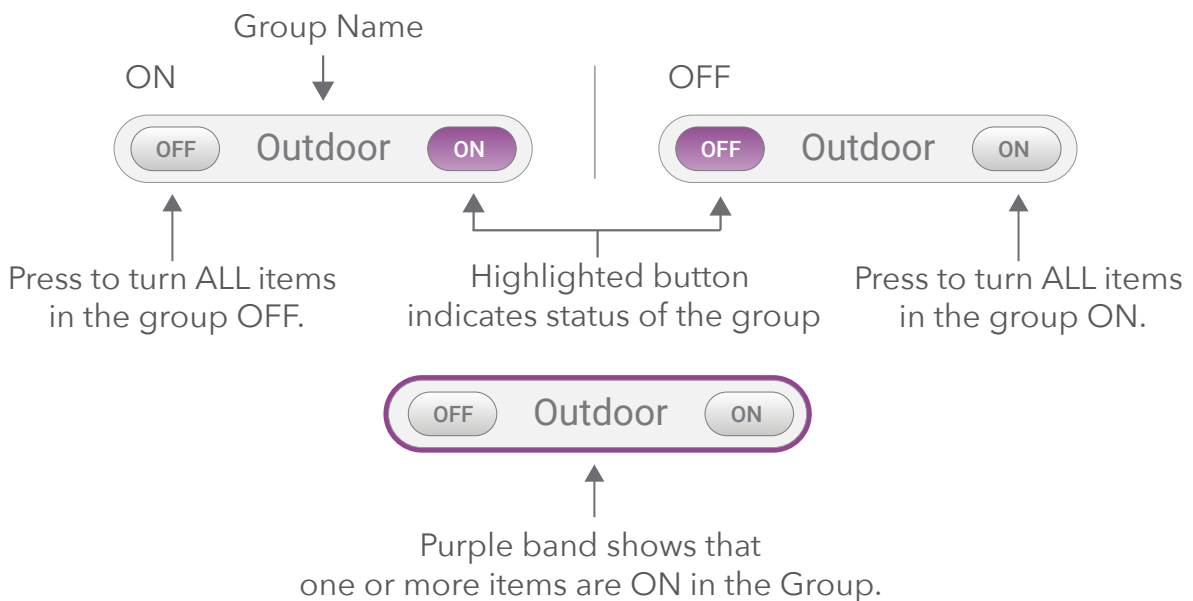

3 - HOME PAGE

This page summarises the main functions connected on your MyPlace system.

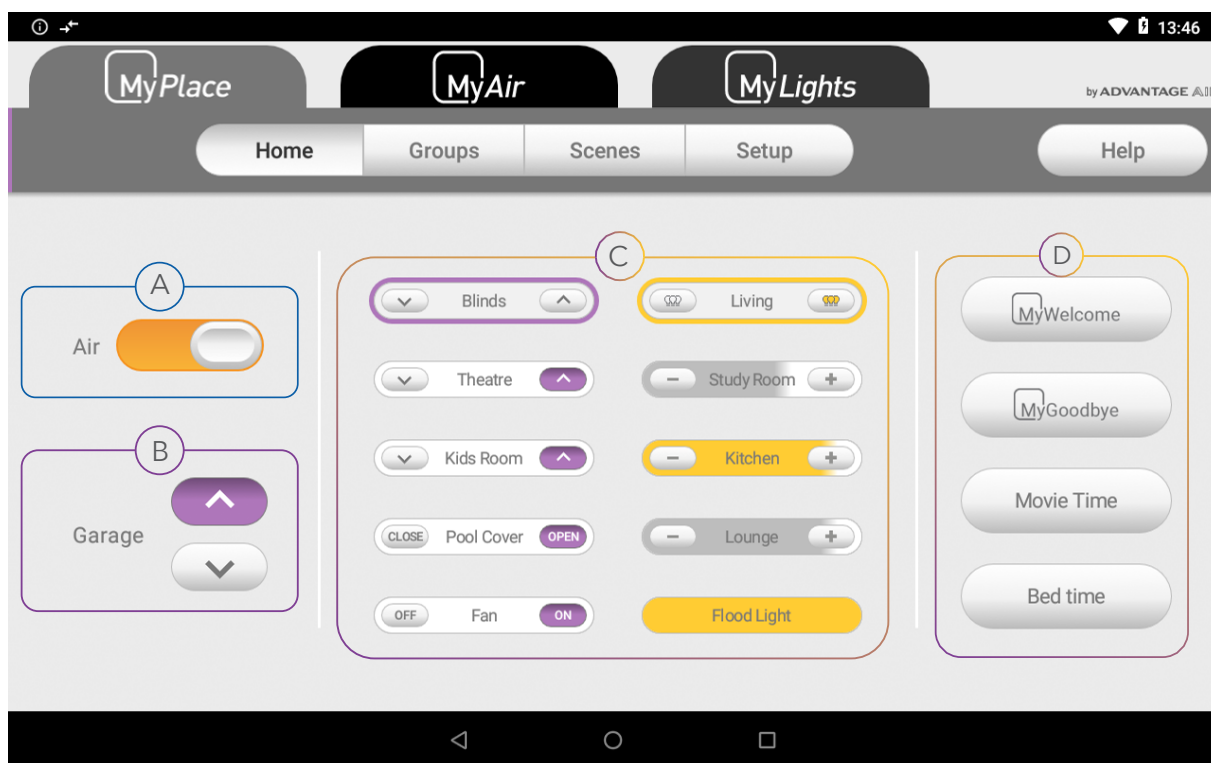

A- Aircon

If you have a MyAir system, you can switch your aircon On and Off from this button. The colour of the button shows the mode that your aircon is currently running.

B- Garage Door

If you have connected your Garage door to the MyPlace system, press this button to open or close your garage door. If you have two or more garage doors, then the first garage door from the groups page will be controlled here.

C- Favourite Groups & Buttons

The middle section of the Home screen displays the most used buttons (device specific). Any groups that have been starred in the Group screen will also be shown in this section. Starred groups will be shown first, followed by the most used buttons.

D- Favourite Scenes

These are your four favourite scenes that have been starred from the Scenes screen. The four scenes can be changed at any time by selecting and deselecting the stars on the Scenes page. Pressing a favourite scene button will run that scene.

4 - GROUP PAGE

The Groups screen enables you to group items into useful groups, such as creating a group for all blinds in your dining room. This allows you to control all of the grouped blinds from a single button.

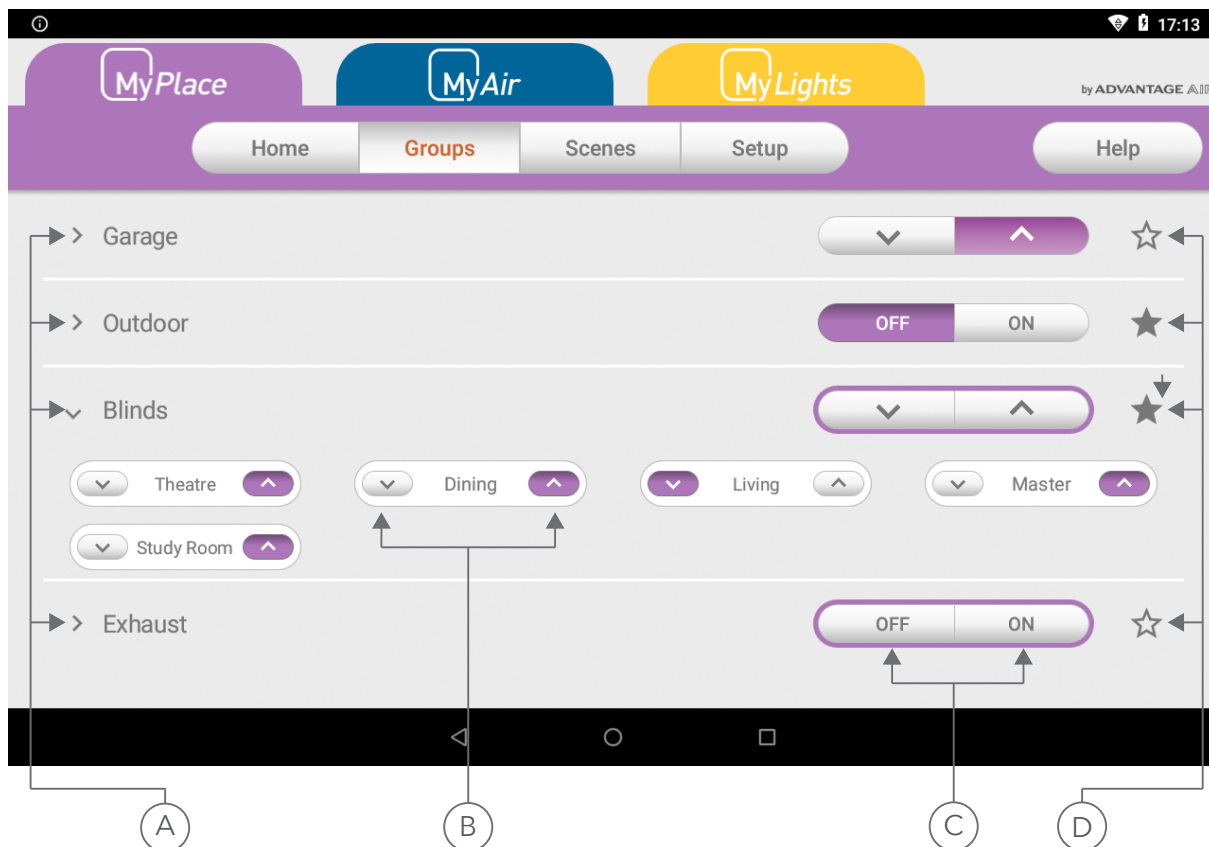

- A** - Press to expand or collapse group.
- B** - Press the item button to individually change its status.
- C** - Press the group buttons to change all items in the group together.
- D** - Press the star button to pin a group to the favourites section of MyPlace Home.

Groups can be created, renamed or deleted through the Manage Groups button found on the Setup screen. Up to 10 groups can be created.

Pressing and holding on a switch icon in the Group screen will allow you to drag the switch into a new position or group.

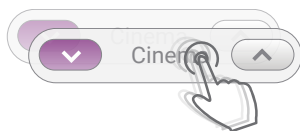

5 - SCENES PAGE

Scenes allow you to set, lights and other items from MyPlace, the way you want them from a single button. There are two types of Scenes; Master Scenes and Custom Scenes.

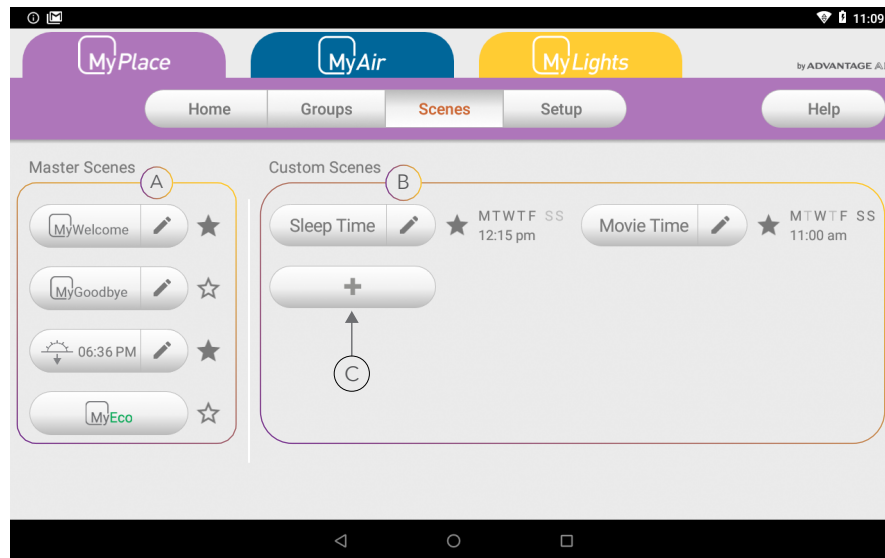

A- Master Scenes

There are 4 master scenes that perform preconfigured functions as follows;

- MyWelcome - Turns ON lights in the system
- MyGoodbye - Turns OFF all the lights
- MyEco - Saves energy by dimming all the dimmable lights to 80%
- MySunset - Turns on all the lights at sunset.

Master Scenes come preconfigured but you can edit MyWelcome, MyGoodbye and MySunset to include some items, ignore others and turn some items ON/OFF.

Note: Scenes that are editable have an edit button shown by the pencil icon. The user can edit the master scene through scene editor.

B- Custom Scenes

You can add up to 8 custom scenes.

C- Creating a Custom Scene

To create a new Custom Scene press the + button. This will bring up the Scene Editor screen. (See the next page for more details.)

6 - SCENES EDITOR PAGE

The Scene Editor screen as shown below is where you can configure any new or existing scenes.

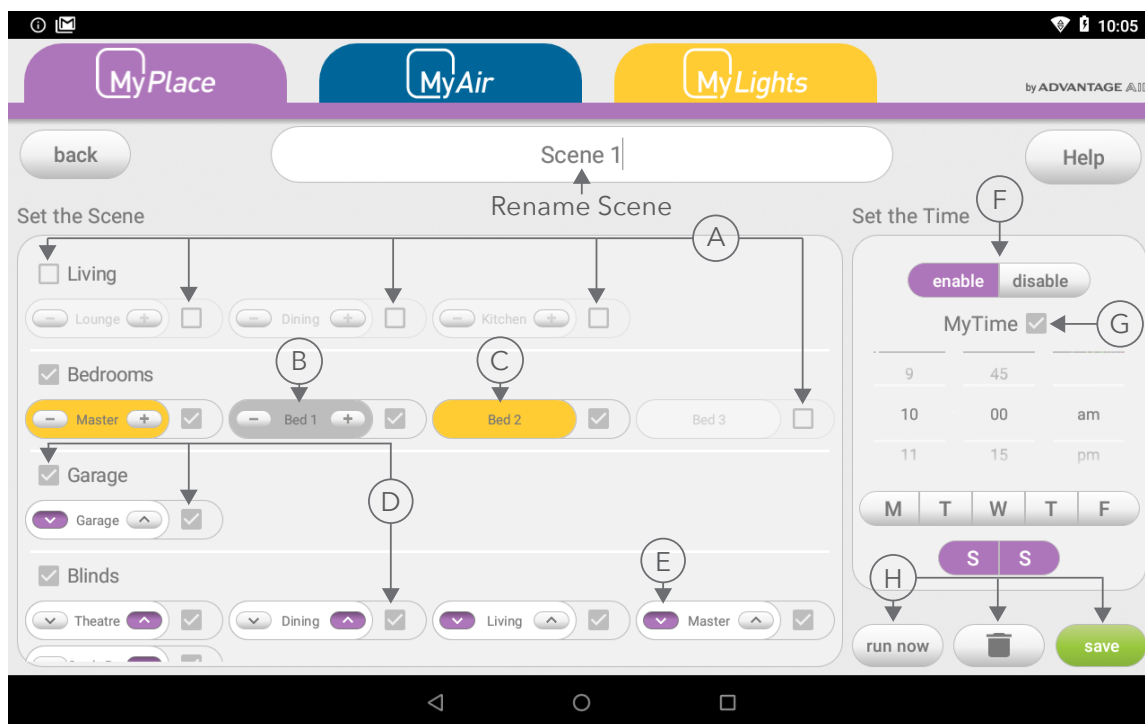

Set the Scene Window

This window allows you to control what the scene will do to your lights and other items when it runs.

- Ⓐ- Unticked Groups and Buttons will be ignored when the scene runs.
- Ⓑ- Lights will turn OFF when the scene runs.
- Ⓒ- Lights will turn ON when the scene runs.
- Ⓓ- Ticked Groups and Buttons are included in the scene.
- Ⓔ- Highlighted Buttons indicate what will happen when the scene runs.

Ⓕ- Set the Time Window

This window allows you to set a time and choose which days for your scene to run. The schedule can be enabled and disabled.

Ⓖ- MyTime

MyTime will tell the lights to slowly turn on the dimmable lights at the set time. Press the checkbox to enable or disable MyTime.

Ⓗ- Saving, Running and Deleting a Scene

All changes to a Scene must be saved by pressing the save button. You can run a scene from the editor screen by pressing the "Run Now" button. If the scene is no longer needed then it can be deleted by pressing the trash button.

7 - SETUP PAGE

The Setup Screen allows you to configure your MyPlace system. From this screen you can perform the following actions:

- (A) Name and Group MyPlace items by pressing Setup Buttons;
- (B) Enable and setup Google Home to talk to Smart Khaya using Options;
- (C) Enable / Disable Remote Access;
- (D) Manage Groups (create, rename & delete);
- (E) Advanced Information about your system; and
- (F) Status messages and codes will appear here.

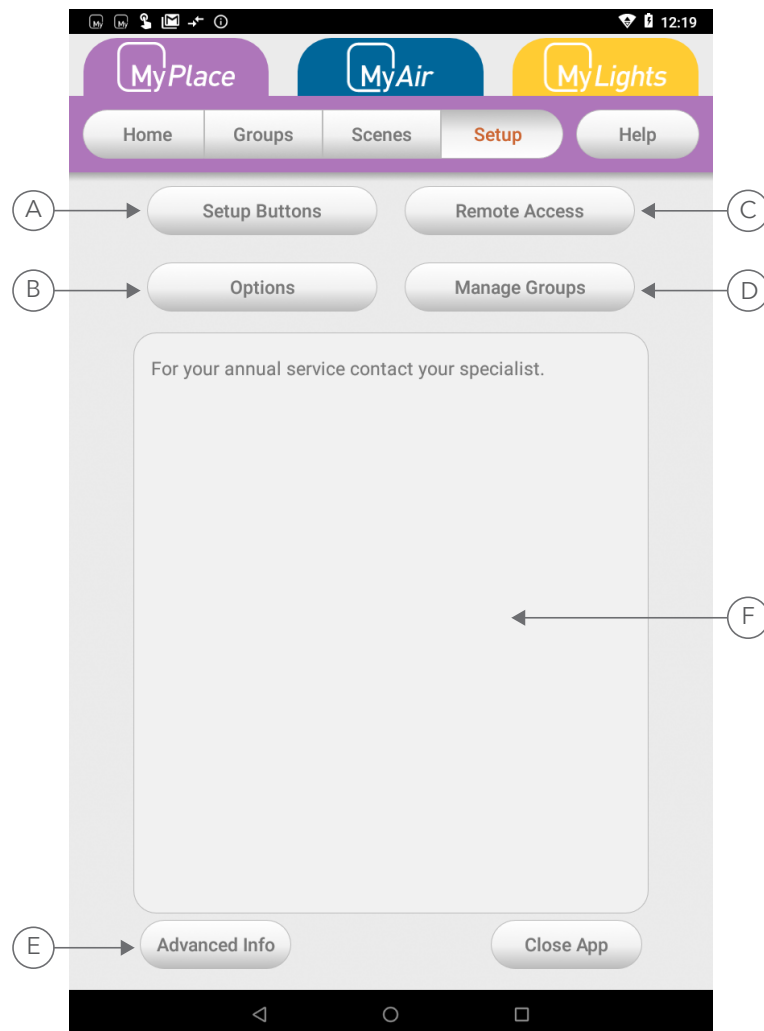

ADVANTAGE AIR®

The advantage of Australian-made

MyLights is designed by Advantage Air, an Australian company based in Perth, Western Australia. Since 1990, we've been dedicated to making peoples' lives more comfortable.

We started with designing and manufacturing innovative ducted air-conditioning systems. The connected smart home, like smart lighting, is the natural evolution of helping you create an environment where everything is exactly the way you like it.

We take pride in creating and exporting a local product that is world class. To achieve this, we embrace technology and invest heavily in research and development. Our ingenious engineers have developed numerous industry firsts and earned us a slew of patents, registered designs and design awards in the process.

We are committed to quality and where possible, make our components in Australia. Like MyAir, your MyPlace system is built to last.

5-Year Warranty

Advantage Air components are well known in the industry for their quality and durability. To prove our confidence, we provide a 5-year warranty on all electronic controls.

Corporate responsibility

Advantage Air is all about bringing comfort to people. We are proud to be a sponsor of Channel 9's Matt & Kim to the rescue. The show delivers life-changing renovations to families in desperate need.

ADVANTAGE AIR®

Australia

Perth

Advantage Air AUST Pty Ltd
115 Vulcan Road, Canning Vale
Western Australia 6155

T: 1300 850 191

E: techsupport@advantageair.com.au

Brisbane

Advantage Air (QLD) Pty Ltd
359 Fison Avenue East, Eagle
Farm, Queensland 4009

Sydney

Advantage Air (NSW) Pty Ltd
7/10 Anella Avenue, Castle Hill,
New South Wales 2154

For further assistance, call our MyTeam Support on 1300 850 191, Mon-Fri from 6am to 5pm WST.

Advantage Air Aust Pty Ltd reserves the right to change specifications, modify designs and discontinue items. Whilst we try to keep every detail in this document current and accurate, if there are differences or changes then Advantage Air shall not be liable for these.